

FPC3000PU

Networked Fingerprint
Door Controller / Reader

Dual Frequencies Card
Live Biometric Sensor
QR Code Reader
OSDP compatible
Unlimited Templates in server



FPC3002-PU

System Configurations

Standalone

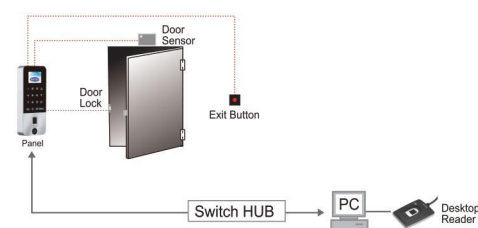

Secure

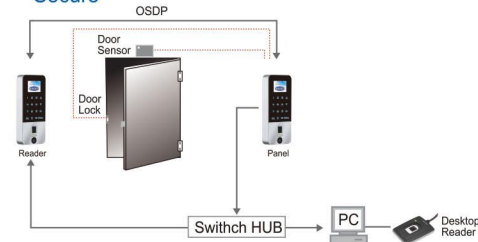

Network

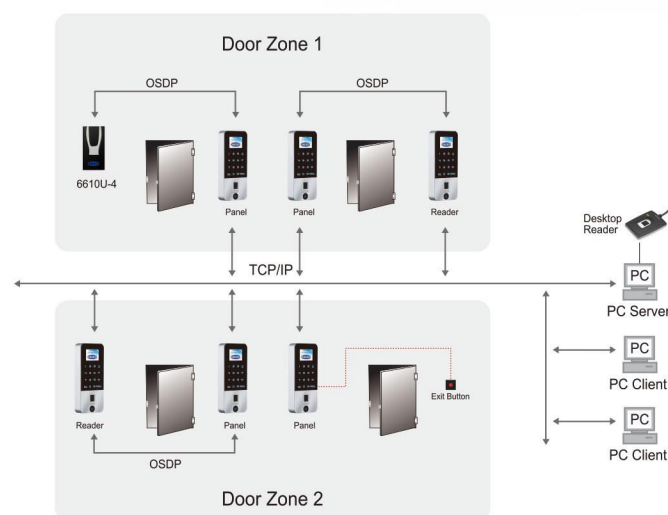

FPC3000PU

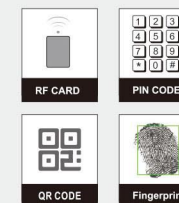
Networked Fingerprint
Door Controller / Reader

Secured Operation:

- No fingerprint picture stored. Proprietary template algorithm.
- Reader Mode : Door operated by door controller in secured area.
- Reader On-Line Mode : no data stored on device.
- Simple Mode : Door controlled by FPC3002, operation uninterrupted with or without network



BioUSB-SC03

Hardware Features

- World's Best Fingerprint Recognition Technology**
 - Cutting-edge algorithm ranked top in Fingerprint field
- Live Biometric Sensor**
 - Live tech Detector, nobody can use fake Fingerprint
 - Semi-conductor fingerprint sensor, High security level
- Ultra Performance**
 - 1:5,000 matches in 1 seconds
- Twice Recognition**
 - Recognition in Terminal only, Server first Recognition

- QR Code**
 - QR code reader built-in, will transfer QR code to controller
- Dual Frequencies Card**
 - 125KHz Proximity card, HID, AWID, KKID; 13.56MHz CPU & Mifare card, Mifare / DesFire, Mifare Sector
- Metal Case**
 - Metal Case, Anti vandal, High Security
- On-Line and Off-Line seamless operation**
 - On-Line: connected to server, Off-Line: Stand-Alone, not connected to server



FPC3001-P/U

Specifications

Model	FPC3001-P/U	FPC3002-PU
CPU	32 bits ARM® Cortex-M4 Processor	
Fingerprint Sensor	Semiconductor	
RF Card Option	P: Proximity, HID, AWID, EM, KKID.	Proximity, HID, AWID, EM, KKID
	U: Mifare/DesFire, Mifare Sector, CPU	Mifare/DesFire, Mifare Sector, CPU
Template Capacity	3,000PCS(5,000 Option) fingerprint with on device memory Unlimited using SPHINX-4 On-Line	
Log Capacity	200,000	
User Fingerprint	up to 3 fingerprints per person	
Communication	TCP/IP 100MBPS Auto Sensing	
PoE	802.3af	
Authorization Mode	Card / Fingerprint, Fingerprint, Card + Fingerprint	Card / Fingerprint / QR code, Fingerprint, Card + Fingerprint, PIN + Card, PIN+ Fingerprint
Wiegand	Wiegand Out	
OSDP	OSDP In & Out	
Tamper	Switch	
Operating Temp	- 20°C ~ 50°C	
Operating Voltage	12vDC, 75mA	12vDC, 300mA; POE, Power Over Ethernet
Dimensions (mm)	H135mm x W45mm x D58mm	H161mm x W66mm x D25mm
Certificates	CE, FCC, RoHS	